

# **Coyote Creek and Jim Creek Timber Marking Contracts# 1 and 2**



**Contract # 1**

**588 acres**

**Contract # 2**

**607 acres**

**Bid Packets available at Omak/Nespelem  
Forestry Office**

**Bid Packets are due 4:00 p.m. August 11,  
2023**

# OMAK/NESPELEM DISTRICT FORESTRY

---

24 Nespelem/San Poil Street Nespelem, WA 99155 (509) 634-2560, fax (509) 634-4721

To All prospective bidders: Marking Contractors.

Omak/Nespelem District Forestry currently has 1 (one) Marking contract available for bid. The estimated acreage is 588.

Marking units are located in the Coyote Creek Timber sale area.

Packets consist of bid sheets, Marking specifications, **work plan** bid evaluation form and maps of the areas. All blocks will be tagged from main roads and laid out with pink and black ribbon, diamonds, tags, and orange paint.

Please include the following with your bid, to be accepted as a successful bidder

- Work Plan
- SAM's. Gov.
- Bid evaluation form
- A copy of your insurance

Selection will be made to the Lowest, Responsive, and Responsible Bidder and due to the short work time frame the main key factor for selection will be made with vendors who can meet that need.

While cost is important other factors are also significant. Consequently, the Colville Tribes may select other than the lowest cost solution to be able to meet the strict time limits.

Contractors should also be aware that the contracts are subject to taxes and 1099's will be mailed out to all contactors.

Bids need to be returned to our office by **4:00 p.m. August 11, 2023**, no faxed bids will be accepted. PLEASE MARK ON THE PACKET "OND MARKING BIDS"

If you have any questions, please contact our office staff Loren Sam at 634-2565 or Tony Stanger 634-2561.

# OMAK/NESPELEM DISTRICT FORESTRY

## Bid Prospectus

### Project open for Bid: Timber Marking

**Project Location:** Contract #1 Is located within the boundaries of the **Coyote Creek Timber Sale**. The blocks are located south of highway 155, along the Coyote Creek Road on the Coyote Creek Timber Sale. Contract #1 is approximately 588 acres and is identified as **Blocks 22, 24, 27, 28, 32, 36, and 50**.

### Narrative of information

Exhibit A	General and Technical specifications
Exhibit B	Quotation for Timber Marking
Exhibit C	Contract Marking Map
Exhibit D	Marking Guidelines
Exhibit E	Work Plan
Exhibit F	MSDS-Material Safety Data Sheet

**Duration of Contract:**           **Start work date: August 29, 2023.**  
  **Completion date: October 13, 2023**

**Information:** Specific information is provided with the Contract specifications and Bid Sheets which are available along with maps at the Omak/Nespelem District Office. Contract packages and bid sheets are available during the hours of 7:30 A.M. - 4:00 P.M. Monday-Friday

**Contact Phone Number: 509-634-2565/ 509-634-2561**

**Bid Sheet Submission: Exhibit "B" Bid Sheets and Exhibit "E" Work Plan must be returned by the closing time and date of 4: 00 P.M. August 11, 2023, to the Omak/Nespelem District Forestry. No faxed bids will be accepted.**

### Bids should take into account:

calculate fuel expense, mileage to and from project site, how many workers, hours a day, slope, road access, and how many acres predicted to complete a day. Marking timber will be selecting to mark or paint leave certain timber species according to the marking guidelines and FEM you receive in your bid packets. You will be required to properly identify Ponderosa Pine, Western Larch, Douglas Fir, Sub Alpine Fir, and Lodge Pole Pine in some cases. An acre is 43,560 sq. ft., or approximately 209' by 209', or approximately the size of a football field. Equipment needs; a paint gun that you will have to purchase on your own or purchase through our program. Yellow / white / blue paint will be supplied from our office. **All contracts that are entered into with the Colville Tribe are required to carry liability insurance.**

**Equipment needs:**

You will be using a paint gun that you will have to purchase on your own, or purchase through our program.

**Tree marking Paint gun prices:** Three types to choose from, Nel-spot Metal Gun DT-105, Nel-spot Plastic Gun LT-104, and Idico Duz-All.

Information is from the following websites. As of July 31, 2023

*(The Nelson Paint Company Website)*

*Nel-Spot guns are backordered but will ship by July 1*

<b>Metal</b> Nel-Spot DT-105 Tree Marking Paint Gun (Metal two finger pull trigger)	SKU:HG0M190	\$309.49
<b>Plastic</b> Nel-Spot Dura-Built LT-104 Tree Marking Paint Gun (Three finger pull trigger)	SKU: HG1080	\$186.69
Idico Duz-All Tree Marking Paint Gun	SKU: HG0K040	\$89.99

---

*(Forestry Suppliers web site)*

<b>Metal</b> Nel-Spot Tree Marking Gun (three finger pull trigger)	item#55831	\$389.95
<b>Plastic</b> Nel-Spot Dura-Built Tree Marking Gun	Item#55909	\$229.95
Idico Duz-All Tree Marking Gun	Item#55807	\$83.25

---

*Pre-order ships in 2-4 days*

\* Check with office for clarification of vendors and prices.



## Exhibit A

### GENERAL AND TECHNICAL SPECIFICATIONS

1. Unit boundaries are identified with Pink/Black striped ribbon; diamonds tags, yellow leave tree tags with block number. RMZ ribbon is orange. Section corners are orange and blue ribbon.
2. Contract Acres are only estimates only with RMZ zones included.
3. All Leave trees will be marked with a **yellow** or **white** paint band completely around the bole (stem of tree) at or above DBH (diameter breast Height) 4.5 ft and a stump mark of yellow paint made below stump height (1 foot above ground on the bole of the tree) on the downhill side of the tree Bole. All paint will be supplied by the Omak/Nespelem District office.
4. Only trees 8 inches or larger at DBH will be marked for leave trees, unless otherwise specified by the Contracting Officer or their designated representative(s).
5. Payment will be made only for work completed in the designated work areas included and identified in the exhibit C.
6. The contractor will dispose of Trash, debris and garbage from or as a part of their operation. Trash, debris, garbage shall be removed daily from the work site.
7. All used and unused cans of paint will be returned to Omak/Nespelem in original cardboard containers and all empty cans of paint shall have the lids removed and residual paint will be dry before cans are returned for inventory to the district.
8. Non return of unused materials, supplies, or tools upon completion of the contract provided for execution of the contract and or inappropriate waste of and or destruction of paint, solvents and or equipment provided as a part of this contract or other supplies provided to contractor shall be deducted from the value of the contract prior to payments for services received.
9. There shall be no marking rocks, logs or any ground materials; spilled paint, graffiti, or defacement. Paint is designated for marking trees only.
10. Paint gun storage and maintenance; keep guns operational by placing guns in diesel or paint thinner to keep the interior parts operating.
11. The Contracting Officer and or representative(s) shall determine inappropriate waste of and or destruction of paint, solvents and or tools and supplies provided for execution of the contract.
12. The contractor and or representative(s) will supervise the operations of marking and at a minimum have skills and experience necessary to interpret maps, distinguish tree species, disease and interpret silviculture objectives provided in the documents identified as marking guides, Fem (field examination report) as part of or in addition to the attachments found in or made a part of the contract.
13. Progress of work shall be maintained daily and provided to the COR as requested.
14. A preliminary operations meeting will be conducted prior to start ORDER, of the project and a field visit to the work area in which operational aspects of the contract will be discussed.
15. Archaeological Notification Provision. If Contractor discovers or has reason to believe they have discovered an object of cultural significance the COR must be informed immediately.

**Exhibit "B"**  
**Quotation for Timber Marking on the Colville Indian Reservation**

**Request for Proposal for Contract number O/N-2**  
**Jim Creek Marking Contract # 2, 2023**

Unit Name and Number	Inspector Item	Bid Method	Estimated Acres	Marking Treatment	Bid Price Per/Acre	Total
Jim Creek 140-19	A	Acre	395	ST/OR		\$
Jim Creek 140-33	B	Acre	148	ST/OR		\$
Jim Creek 140-307	C	Acre	64	ST/OR		\$
<b>Estimated Total</b>			<b>607</b>			
					<b>Total</b>	<b>\$</b>

\*\*\*\*\*

**NAME OF FIRM:** \_\_\_\_\_

BY (TITLE): \_\_\_\_\_

ADDRESS: \_\_\_\_\_

CITY/STATE/ZIP: \_\_\_\_\_

**PHONE NUMBER:** \_\_\_\_\_ **ALTERNATE:** \_\_\_\_\_

(Please include a phone number where you can be reached)

INDIAN PREFERENCE BIDDER: YES: \_\_\_\_\_ NO: \_\_\_\_\_

IF YES, TRIBE: \_\_\_\_\_ **ENROLLMENT #:** \_\_\_\_\_

BIDS WILL BE RECEIVED AT THE OMAK/NESPELEM DISTRICT FORESTRY OFFICE UNTIL 4:00 P.M. ON  
**August 11, 2023**  
 IF BIDS ARE MAILED, THEY MUST BE RECEIVED ON OR BEFORE THE ABOVE MENTIONED DATE.  
 BIDS RECEIVED AFTER THIS DATE WILL BE REJECTED.

SUBMIT BIDS IN A SEALED ENVELOPE LABELED **OND TIMBER MARKING BIDS**, TO  
 OMAK/NESPELEM DISTRICT FORESTRY 24 Nespelem / San Poil Street Nespelem WA 99155

COLVILLE TRIBES RESERVES THE RIGHT TO ACCEPT OR REJECT ANY OR ALL BIDS.  
**Do not forget to fill out work Plan**

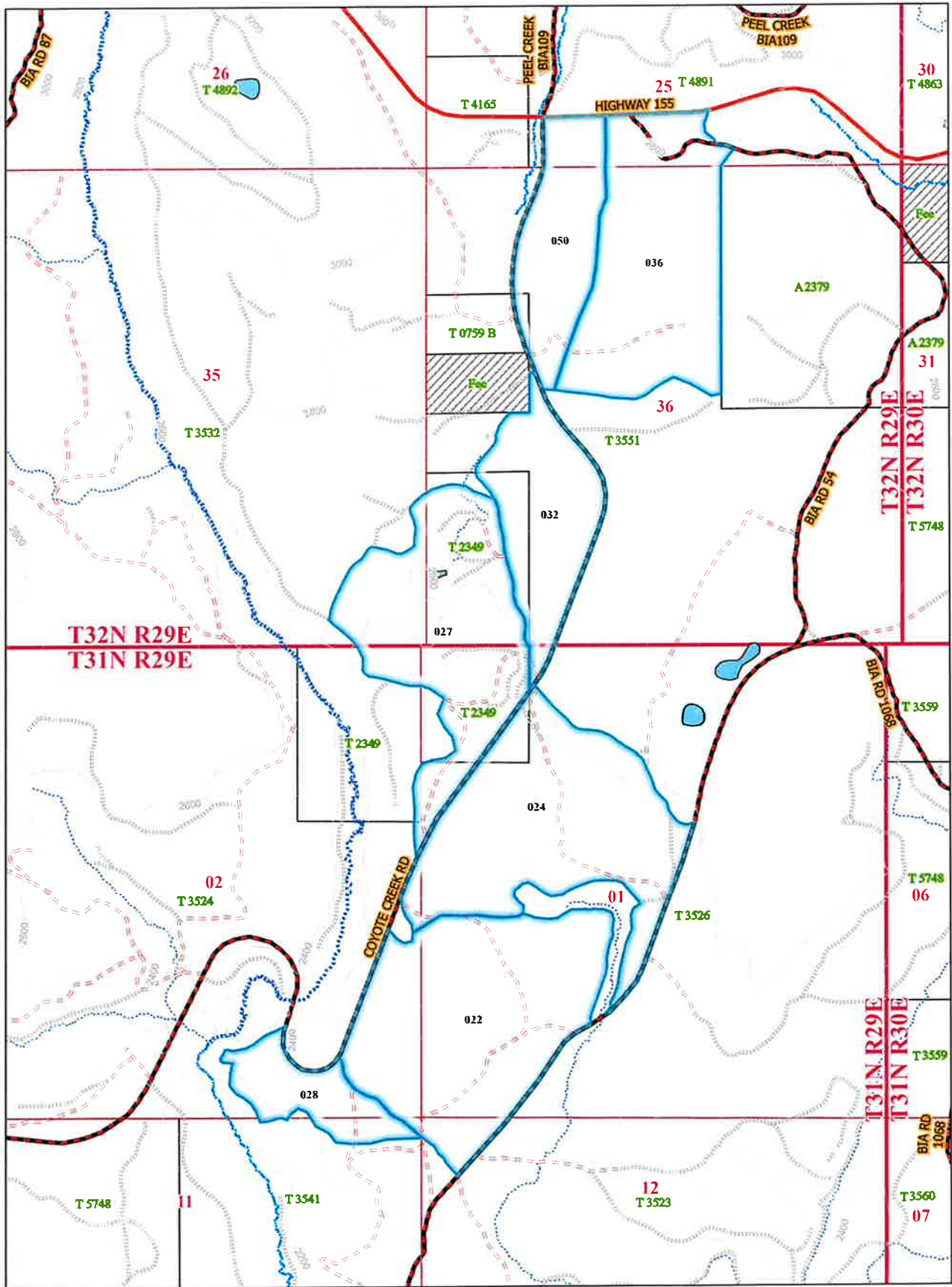

Coyote Creek Marking Contract Blocks Exhibit 'C'



Coyote Creek Sale  
Marking Contract Blocks

Compartment	Blocks	Acres	Rx
135	22	129	ST/OR
135	24	120	ST/OR
135	27	102	ST/OR
135	28	29	ST/OR
135	32	57	ST/OR
135	36	103	ST/OR
135	50	49	ST/OR
<b>Total</b>		<b>588</b>	

- Legend**
- Marking Contract Blocks CONTOURS**
- 40 ft.
  - 200 ft.
- Roads**
- Proposed
  - - - Reconstruct
  - BIA, COUNTY
  - Existing
  - - - INACTIVE
  - State
- Streams**
- Type I
  - Type II
  - Type III
  - Type IV

- Sections**
- 35
- Ownership**
- Allotment Trust
  - Private Fee
  - Tnbal Fee
  - Tnbal Reserve
  - Tnbal Trust

Exhibit D Marking Guidelines Coyote Creek 2023

Coyote Creek					
Comp 135	Block 022	Rx ST/OR	Acres 132.2	BAF 10	Date 3-Feb-23
ELEV 2298 ft	ASPECT W	SLOPE 28%	SITE INDX 65	PRECIP 13 in	Root DPTH 54 cm

Spp	Class	DBH	Ht	TPA	BA	NetBF	CutBF	CutBA
DF	2	12.8	51	2	2	92	75	1
DF	3	17.4	67	1	1	61	50	0.5
DF	4	20.5	78	0	1	88	75	0.5
PP	1	0.6	8	350	1	0		
PP	2	12	67	48	38	2,474	2,100	33
PP	3	16.6	87	31	46	4,505	3,700	40
PP	4	21.9	101	3	7	1,156	925	5
<b>PP..</b>		<b>6.4</b>		<b>435</b>	<b>96</b>	<b>8,376</b>	<b>6,925</b>	<b>80</b>

- DF: sweep
- PP: DMT infected = 3%, Avg DMT Rating = 2; sweep; multi tops
- WL: minor volume in block

Spp. Preference: 1 = WL, 2 = PP, 3 = DF

Remove all DMT in PP/DF. Leave majority of WL (DMT rating 2 or less) where available. Prefer Seed Trees from 12" to 20" DBH with healthiest, most vigours crowns. Leave 1 to 3 TPA of WL, PP, or DF with +25" DBH where available, groups/clusters okay. Save regen where able, evaluate after logging for PCT/ Weeding of brush, LP, or DMT in understory. WholeTree skid and Lop & Scatter to concentrate/ dispose of slash loading and site prep for natural regen/Adv Regen. Distribute some slash from landings on skid trails for soil/water protection and reduced landing pile size.

**Cut History / Future Treatments**

<u>Treatment</u>	<u>Year</u>
Overstory Removal/PCT	1982
SeedTree/Overstory Removal	2022
Pre-Commercial Thin	2030
1st Commercial Thin	2052
Irregular ShelterWood	2082
SeedTree/Overstory Removal	2097
Pre-Commercial Thin	2105



Exhibit D Marking Guidelines Coyote Creek 2023

Coyote Creek					
Comp 135	Block 024	Rx ST/OR	Acres 119.5	BAF 10	Date 3-Feb-23
ELEV 2560 ft	ASPECT SW	SLOPE 12%	SITE INDX 58	PRECIP 13 in	Root DPTH 20 cm

Spp	Class	DBH	Ht	TPA	BA	NetBF	CutBF	CutBA
DF	1	2.1	25	113	3	0		
DF	2	11	58	9	6	331	275	5
DF	3	16.7	82	3	4	385	300	3
DF	4	22.3	96	1	2	230	175	1
LP	1	1.9	24	17	0	0		
LP	2	10	59	1	0	28	28	0
PP	1	1.6	25	477	6	0		
PP	2	11.4	53	25	18	1,095	875	15
PP	3	16.9	82	13	20	2,096	1,675	16
PP	4	22.7	97	5	13	1,769	1,425	10
WL	1	2.3	24	5	0	0		0
WL	2	11.4	67	1	1	61	25	0
WL	3	16	93	0	0	51	20	0
<b>PPCX</b>		<b>4.5</b>		<b>669</b>	<b>74</b>	<b>6,046</b>	<b>4,798</b>	<b>50</b>

- DF: sweep
- PP: DMT infected = 6%, Avg DMT Rating = 2; sweep; fork/multi tops; bole cracks
- WL: minor volume in block; healthy

Spp. Preference: 1 = WL, 2 = PP, 3 = DF

Remove all DMT in PP/DF. Leave majority of WL (DMT rating 2 or less) where available. Prefer Seed Trees from 12" to 20" DBH with healthiest, most vigours crowns. Leave 1 to 3 TPA of WL, PP, or DF with +25" DBH where available, groups/clusters okay. Save regen where able, evaluate after logging for PCT/ Weeding of brush, LP, or DMT in understory. WholeTree skid and Lop & Scatter to concentrate/ dispose of slash loading and site prep for natural regen/Adv Regen. Distribute some slash from landings on skid trailsfor soil/water protection and reduced landing pile size.

**Cut History / Future Treatments**

<u>Treatment</u>	<u>Year</u>
Overstory Removal	1982
SeedTree/Overstory Removal	2022
Pre-Commercial Thin	2025
1st Commerical Thin	2052
Irregular ShelterWood	2082
SeedTree/Overstory Removal	2097
Pre-Commercial Thin	2105

Exhibit D Marking Guidelines Coyote Creek 2023

Coyote Creek					
Comp	Block	Rx	Acres	BAF	Date
135	027	ST/OR	82.5	10	3-Feb-23
ELEV	ASPECT	SLOPE	SITE INDX	PRECIP	Root DPTH
2580 ft	SW	10%	65	13 in	44 cm

Spp	Class	DBH	Ht	TPA	BA	NetBF	CutBF	CutBA
DF	1	2.1	26	71	2	0		
DF	2	11.2	57	6	4	241	200	3
DF	3	17	81	2	3	313	250	2
DF	4	21.5	95	0	1	140	100	1
PP	1	1.7	26	342	5	0		
PP	2	11.5	54	20	15	837	675	12
PP	3	17.1	77	8	13	1,282	1025	10
PP	4	22.7	98	3	8	1,081	875	6
WL	1	1.7	22	5	0			
WL	2	10.7	66	0	0	11	5	
<b>PPCX</b>		<b>4.5</b>		<b>458</b>	<b>52</b>	<b>3,904</b>	<b>3,130</b>	<b>34</b>

- DF: DMT infected = 15%, Avg DMT Rating = 1; sweep
- PP: DMT infected = 15%, Avg DMT Rating = 2; sweep; snags; fork/multi tops
- WL: minor volume in block; healthy

Spp. Preference: 1 = WL, 2 = PP, 3 = DF

Remove all DMT in PP/DF. Leave majority of WL (DMT rating 2 or less) where available. Prefer Seed Trees from 12" to 20" DBH with healthiest, most vigours crowns. Leave 1 to 3 TPA of WL, PP, or DF with +25" DBH where available, groups/clusters okay. Save regen where able, evaluate after logging for PCT/ Weeding of brush, LP, or DMT in understory. WholeTree skid and Lop & Scatter to concentrate/ dispose of slash loading and site prep for natural regen/Adv Regen. Distribute some slash from landings on skid trailsfor soil/water protection and reduced landing pile size.

**Cut History / Future Treatments**

<u>Treatment</u>	<u>Year</u>
Commercial Thin	2005
SeedTree/Overstory Removal	2022
Pre-Commercial Thin	2030
1st Commerical Thin	2052
Irregular ShelterWood	2082
SeedTree/Overstory Removal	2097
Pre-Commercial Thin	2105

Exhibit D Marking Guidelines Coyote Creek 2023

Coyote Creek					
Comp 135	Block 028	Rx ST/OR	Acres 28.6	BAF 10	Date 3-Feb-23
ELEV 2560 ft	ASPECT SW	SLOPE 12%	SITE INDX 58	PRECIP 13 in	Root DPTH 20 cm

Formerly 135019

Spp	Class	DBH	Ht	TPA	BA	NetBF	CutBF	CutBA
DF	1	1	10	22	0	0		
DF	2	11.3	56	2	1	65	50	0.5
DF	3	17.4	73	1	1	103	80	0.5
PP	1	1.4	27	347	4	0		
PP	2	11.8	61	39	29	1,921	1,525	24
PP	3	16.7	80	16	24	2,518	2,025	19
PP	4	21.3	90	4	10	1,235	975	8
<b>PP..</b>		<b>5.5</b>		<b>430</b>	<b>70</b>	<b>5,843</b>	<b>4,655</b>	<b>52</b>

- DF: sweep
- PP: DMT infected = 8%, Avg DMT Rating = 2; sweep; fork/multi tops; dead tops; snags
- WL: minor volume in block

Spp. Preference: 1 = WL, 2 = PP, 3 = DF

Remove all DMT in PP/DF. Leave majority of WL (DMT rating 2 or less) where available. Prefer Seed Trees from 12" to 20" DBH with healthiest, most vigours crowns. Leave 1 to 3 TPA of WL, PP, or DF with +25" DBH where available, groups/clusters okay. Save regen where able, evaluate after logging for PCT/ Weeding of brush, LP, or DMT in understory. WholeTree skid and Lop & Scatter to concentrate/ dispose of slash loading and site prep for natural regen/Adv Regen. Distribute some slash from landings on skid trailsfor soil/water protection and reduced landing pile size.

**Cut History / Future Treatments**

<u>Treatment</u>	<u>Year</u>
Overstory Removal/PCT	1982
SeedTree/Overstory Removal	2022
Pre-Commercial Thin	2025
1st Commerical Thin	2052
Irregular ShelterWood	2082
SeedTree/Overstory Removal	2097
Pre-Commercial Thin	2105

Exhibit D Marking Guidelines Coyote Creek 2023

Coyote Creek					
Comp 135	Block 032	Rx ST/OR	Acres 56.2	BAF 10	Date 3-Feb-23
ELEV 2669 ft	ASPECT SW	SLOPE 10%	SITE INDX 61	PRECIP 14 in	Root DPTH 24 cm

Spp	Class	DBH	Ht	TPA	BA	NetBF	CutBF	CutBA
DF	1	0.8	11	136	0	0		
DF	2	10.3	42	1	1	26	20	1
DF	3	17.4	76	2	3	271	220	2
DF	4	20.3	80	1	2	144	120	1
PP	1	1.1	11	214	1	0		
PP	2	11.8	62	22	17	997	800	14
PP	3	16.9	81	11	17	1,620	1300	13
PP	4	22.8	106	2	5	743	600	4
QA	1	2.3	16	30	1			
QA	2	12.2	53	1	1			
<b>PP..</b>		<b>4.6</b>		<b>420</b>	<b>48</b>	<b>3,800</b>	<b>3,060</b>	<b>35</b>

- DF: DMT infected = 14%, Avg DMT Rating = 1; sweep
- PP: DMT infected = 18%, Avg DMT Rating = 2; sweep; snags; fork/multi tops
- WL: minor volume in block; healthy

Spp. Preference: 1 = WL, 2 = PP, 3 = DF

Remove all DMT in PP/DF. Leave majority of WL (DMT rating 2 or less) where available. Prefer Seed Trees from 12" to 20" DBH with healthiest, most vigours crowns. Leave 1 to 3 TPA of WL, PP, or DF with +25" DBH where available, groups/clusters okay. Save regen where able, evaluate after logging for PCT/ Weeding of brush, LP, or DMT in understory. WholeTree skid and Lop & Scatter to concentrate/ dispose of slash loading and site prep for natural regen/Adv Regen. Distribute some slash from landings on skid trailsfor soil/water protection and reduced landing pile size.

**Cut History / Future Treatments**

Treatment	Year
Commercial Thin	2005
SeedTree/Overstory Removal	2022
Pre-Commercial Thin	2030
1st Commerical Thin	2052
Irregular ShelterWood	2082
SeedTree/Overstory Removal	2097
Pre-Commercial Thin	2105



Exhibit D Marking Guidelines Coyote Creek 2023

Coyote Creek					
Comp 135	Block 036	Rx ST/OR	Acres 102.9	BAF 10	Date 14-Nov-22
ELEV 3589 ft	ASPECT NW	SLOPE 40%	SITE INDX 67	PRECIP 17 in	Root DPTH 28 cm

Spp	Class	DBH	Ht	TPA	BA	NetBF	CutBF	CutBA
DF	1	1.5	19	199	2	0		
DF	2	11.6	70	14	10	644	500	8
DF	3	16.9	85	7	10	837	775	8
DF	4	21.8	90	1	3	362	275	2
LP	3	18.4	71	0	1	70	70	1
PP	1	1.9	22	158	3	0		
PP	2	11.2	62	61	42	2,227	1750	33
PP	3	16.9	78	18	27	2,167	1750	22
PP	4	22.4	96	3	8	825	650	6
WL	3	15.9	63	2	2	156	75	1
<b>PPDF</b>		<b>6.6</b>		<b>462</b>	<b>110</b>	<b>7,290</b>	<b>5,845</b>	<b>81</b>

- DF: DMT infected = 13%, Avg DMT Rating = 2; sweep
- PP: DMT infected = 1%, Avg DMT Rating = 1; sweep; snags; fork/multi tops
- WL: minor volume in block; healthy

Spp. Preference: 1 = WL, 2 = PP, 3 = DF

Remove all DMT in PP/DF. Leave majority of WL (DMT rating 2 or less) where available. Prefer Seed Trees from 12" to 20" DBH with healthiest, most vigours crowns. Leave 1 to 3 TPA of WL, PP, or DF with +25" DBH where available, groups/clusters okay. Save regen where able, evaluate after logging for PCT/ Weeding of brush, LP, or DMT in understory. WholeTree skid and Lop & Scatter to concentrate/ dispose of slash loading and site prep for natural regen/Adv Regen. Distribute some slash from landings on skid trailsfor soil/water protection and reduced landing pile size.

**Cut History / Future Treatments**

<u>Treatment</u>	<u>Year</u>
Sanitation (partial)	2005
SeedTree/Overstory Removal	2022
Pre-Commercial Thin	2030
1st Commerical Thin	2052
Irregular ShelterWood	2082
SeedTree/Overstory Removal	2097
Pre-Commercial Thin	2105

Exhibit D Marking Guidelines Coyote Creek 2023

Coyote Creek					
Comp 135	Block 050	Rx ST/OR	Acres 49.4	BAF 10	Date 14-Nov-22
ELEV 2848	ASPECT S	SLOPE 18%	SITE INDX 64	PRECIP 6in	Root DPTH 25 cm

Spp	Class	DBH	Ht	TPA	NetBF	BA	CutBF	CutBA
DF	1	0.8	8	79	0	0		
DF	2	11.1	68	3	117	2	95	1
PP	1	1.4	10	184	0	2		
PP	2	12.5	62	33	1,527	28	1250	23
PP	3	16.6	77	20	2,626	30	2150	25
PP	4	22.8	94	4	1,329	11	1000	8
<b>PP..</b>		<b>6.5</b>		<b>323</b>	<b>5,598</b>	<b>74</b>	<b>4,495</b>	<b>57</b>

- DF: sweep; snags = 30%
- PP: bole damage; sweep; snags = 3%
- WL: minor volume in block

Spp. Preference: 1 = WL, 2 = PP, 3 = DF

Remove all DMT in PP/DF. Leave majority of WL (DMT rating 2 or less) where available. Prefer Seed Trees from 12" to 20" DBH with healthiest, most vigours crowns. Leave 1 to 3 TPA of WL, PP, or DF with +25" DBH where available, groups/clusters okay. Save regen where able, evaluate after logging for PCT/ Weeding of brush, LP, or DMT in understory. WholeTree skid and Lop & Scatter to concentrate/ dispose of slash loading and site prep for natural regen/Adv Regen. Distribute some slash from landings on skid trailsfor soil/water protection and reduced landing pile size.

**Cut History / Future Treatments**

<u>Treatment</u>	<u>Year</u>
Sanitation (partial)	2005
SeedTree/Overstory Removal	2022
Pre-Commercial Thin	2030
1st Commerical Thin	2052
Irregular ShelterWood	2082
SeedTree/Overstory Removal	2097
Pre-Commercial Thin	2105

# OMAK/NESPELEM DISTRICT FORESTRY

## Exhibit "E"

FOREST      DEVELOPMENT      TIMBER SALES      PRESALES  
    FOREST ENGINEERING      SILVICULTURE



### Contractors Work Plan

Date \_\_\_\_\_ Activity \_\_\_\_\_

Contractor \_\_\_\_\_ Foreman \_\_\_\_\_

Phone # \_\_\_\_\_ Phone # \_\_\_\_\_

Alternate #'s \_\_\_\_\_

### Name of Workers

_____	_____
_____	_____
_____	_____
_____	_____
_____	_____
_____	_____
_____	_____

### Comments

(E.G., start date, start time, meeting place #workers, daily,  
Weekly work schedule, #acres per day, completion  
Date.)

\_\_\_\_\_

\_\_\_\_\_

\_\_\_\_\_

\_\_\_\_\_

\_\_\_\_\_

\_\_\_\_\_

\_\_\_\_\_

\_\_\_\_\_

\_\_\_\_\_

\_\_\_\_\_

Contractor Signature \_\_\_\_\_ Date \_\_\_\_\_

**Complete and include this Work Plan with your completed Bid Sheets**

# BID EVALUATION FORM

Contractor Name: \_\_\_\_\_

Business Name: \_\_\_\_\_

1.) Do you currently hold any other contracts? \_\_\_ Yes \_\_\_ No

Contract Type	Completion Date	District	COR

2.) Have you or you Company ever been "defaulted"? \_\_\_ Yes \_\_\_ No

If yes, date of default \_\_\_\_\_, from whom \_\_\_\_\_

3.) These items listed below must be included with your bid including this form.

a. Do you have insurance \_\_\_ Yes \_\_\_ No if no, where to you plan on getting?  
the insurance \_\_\_\_\_

b. Are you TERO certified \_\_\_ Yes \_\_\_ No Make sure you are up to date.  
Enclose your Certificate.

c. Will you subcontract any of you work? \_\_\_ Yes \_\_\_ No

Name of subcontractor: \_\_\_\_\_

Is the subcontractor Indian Owned? \_\_\_ Yes \_\_\_ No



**Exhibit “F”**  
Super-Spot Tree Mark-All Color  
MSDS

\*\*\*\*\*  
**MATERIAL SAFETY DATA SHEET**  
 \*\*\*\*\*

\*\*\*\*\*  
**SECTION I - CHEMICAL PRODUCT AND COMPANY IDENTIFICATION**  
 \*\*\*\*\*

PRODUCT NAME : SUPER-SPOT TREE MARK-ALL COLOR  
 IDENTIFICATION NUMBER : E&I 23 20  
 PRODUCT USE/CLASS :

DATE PRINTED: 05/30/02

SUPPLIER:  
 The Nelson Paint Co of Michigan Inc  
 PO Box 2040  
 Kingsford, MI 49802-2040

MANUFACTURER:  
 The Nelson Paint Co of Michigan Inc  
 PO Box 2040  
 Kingsford, MI 49802-2040

EMERGENCY TELEPHONE : 800-255-3924  
 CHEMTEL : 24 hours

EMERGENCY TELEPHONE : 800-255-3924  
 CHEMTEL : 24 hours

PREPARER: Doyle Yoder, PHONE: 906-774-5566, PREPARE DATE: 05/09/02

\*\*\*\*\*  
**SECTION II - COMPOSITION / INFORMATION ON INGREDIENTS**  
 \*\*\*\*\*

CHEMICAL NAME	CAS NUMBER	WT. PERCENT		OCCUPATIONAL EXPOSURE LIMITS				SKIN
		IS LESS THAN	TLV-TWA	TLV-STEL	PEL-TWA	PEL-CEILING		
Methyl Alcohol	67-56-1	15.0 %	200ppm	250ppm	200ppm	N.E.	YES	
Aliphatic Hydrocarbons	8052-41-3	35.0 %	100ppm	N.E.	100ppm	N.E.	NO	

(See Section XI for abbreviation legend)

\*\*\*\*\*  
**SECTION III - PHYSICAL DATA**  
 \*\*\*\*\*

BOILING RANGE :	147 - 385 F	VAPOR DENSITY :	Is heavier than air
ODOR :	Slight Solvent	SPECIFIC GRAVITY :	0.9882
APPEARANCE :	Colored Liquid	EVAPORATION RATE :	Is faster than Butyl Acetate
SOLUBILITY IN H2O :	Partial		
VOLATILE BY WEIGHT :	73.4 %	VOLATILE BY VOLUME :	84.1 %
VOCS, lbs/gal :	5.09	VOCS, grams/ltr :	610

(See Section XI for abbreviation legend)

\*\*\*\*\*  
**SECTION IV - FIRE AND EXPLOSION HAZARD DATA**  
 \*\*\*\*\*

FLASH POINT : 73 F	LOWER EXPLOSIVE LIMIT :	1.0 %
	UPPER EXPLOSIVE LIMIT:	36.0 %

EXTINGUISHING MEDIA : ALCOHOL FOAM CO2 DRY CHEMICAL FOAM

UNUSUAL FIRE AND EXPLOSION HAZARDS: Avoid breathing dusts and fumes from burning material. Vapors may form explosive mixture with air. Vapors can travel to a source of ignition and flash back. "Empty" containers retain product residue (liquid and/or vapor) and can be dangerous. DO NOT PRESSURIZE, CUT, WELD, BRAZE, SOLDER, DRILL, GRIND, OR EXPOSE SUCH CONTAINERS TO HEAT, FLAME, SPARKS, STATIC ELECTRICITY, OR OTHER SOURCES OF IGNITION; THEY MAY EXPLODE AND CAUSE INJURY OR DEATH. Empty drums should be completely drained, properly bunged and promptly returned to a drum reconditioner, or properly disposed of. Keep containers tightly closed. Isolate from heat, electrical equipment, sparks and open flame. Closed containers may explode when exposed to extreme heat.

SPECIAL FIREFIGHTING PROCEDURES: Containers can build up pressure if exposed to heat (fire). As in any fire, wear self-contained breathing apparatus pressure-demand (MSHA/NIOSH approved or equivalent) and full protective gear. Water runoff can cause environmental damage. Dike and collect water used to fight fire. Water spray may be used for cooling containers to prevent possible pressure build-up and auto-ignition or explosion when exposed to extreme heat.

\*\*\*\*\*  
**SECTION V - HEALTH HAZARD DATA**  
 \*\*\*\*\*

EFFECTS OF OVEREXPOSURE - EYE CONTACT: Liquid, aerosols and vapors of this product are irritating and can cause pain, tearing, reddening and swelling accompanied by a stinging sensation and/or a feeling like that of fine dust in the eyes.

EFFECTS OF OVEREXPOSURE - SKIN CONTACT: Prolonged or repeated contact can result in defatting and drying of the skin which may result in skin irritation and dermatitis (rash).

EFFECTS OF OVEREXPOSURE - INHALATION: Headaches, dizziness, nausea, decreased blood pressure, changes in heart rate and cyanosis (characterized by bluish discoloration of the skin and nails) may result from over-exposure to vapor or skin exposure.

EFFECTS OF OVEREXPOSURE - INGESTION: This material may be harmful or fatal if swallowed.

EFFECTS OF OVEREXPOSURE - CHRONIC HAZARDS: Reports have associated repeated and prolonged occupational overexposure to solvents with permanent brain and nervous system damage. Intentional misuse by deliberately concentrating and inhaling the contents may be harmful or fatal.

FIRST AID - EYE CONTACT: Immediately flush eyes with plenty of water for 15 minutes. Get immediate medical attention.

FIRST AID - SKIN CONTACT: Immediately flush skin with plenty of water. Wash with soap and water. Remove soiled clothing. Wash clothing separately before reuse. Get medical attention if irritation develops or persists.

FIRST AID - INHALATION: Remove to fresh air. If not breathing, give artificial respiration. If breathing is difficult, give oxygen. Get immediate medical attention.

FIRST AID - INGESTION: NOTE TO PHYSICIAN: This product contains methanol which can cause intoxication and central nervous system depression. Methanol is metabolized to formic acid and formaldehyde. These metabolites can cause metabolic acidosis, visual disturbances and blindness. Since metabolism is required for these toxic symptoms, their onset may be delayed from 6 to 30 hours following ingestion. Ethanol competes for the same metabolic pathway and has been used to prevent methanol metabolism. Ethanol administration is indicated in symptomatic patients or at methanol concentrations above 20 UG/DL. Methanol is effectively removed by hemodialysis. Keep person warm, quiet and get immediate medical attention. Do NOT induce vomiting, because aspiration of material into the lungs from vomiting can cause chemical pneumonitis which can be fatal.

PRIMARY ROUTE(S) OF ENTRY: SKIN CONTACT SKIN ABSORPTION INHALATION INGESTION EYE CONTACT

\*\*\*\*\*  
SECTION VI - REACTIVITY DATA  
\*\*\*\*\*

HAZARDOUS DECOMPOSITION PRODUCTS: Hazardous decomposition products: CO, CO2 and Nox.

CONDITIONS TO AVOID: Heat, sparks and open flames.

INCOMPATIBILITY: Avoid contact with: strong oxidizing agents.

HAZARDOUS POLYMERIZATION: Will not occur under normal conditions.

STABILITY: This product is stable under normal storage conditions.

\*\*\*\*\*  
SECTION VII - SPILL OR LEAK PROCEDURES  
\*\*\*\*\*

STEPS TO BE TAKEN IN CASE MATERIAL IS RELEASED OR SPILLED: Evacuate all non-essential personnel. Remove all sources of ignition. Ventilate the area. Equip employees with appropriate protection equipment. Dike around spilled material. Cover spill with absorbent material and shovel with non-sparking tools into container. Remove containers to safe area and seal. Avoid runoff into storm sewers and ditches which lead to waterways.

WASTE DISPOSAL METHOD: Dispose of in accordance with all local, state and federal regulations.

\*\*\*\*\*  
SECTION VIII - SAFE HANDLING AND USE INFORMATION  
\*\*\*\*\*

RESPIRATORY PROTECTION: A NIOSH/MSHA approved air purifying respirator with an organic vapor cartridge or canister may be permissible under certain circumstances where airborne concentrations are expected to exceed exposure limits. Protection provided by air purifying respirators is limited. Use a positive pressure air supplied respirator if there is any potential for an uncontrolled release, exposure levels are not known, or any other circumstances where air purifying respirators may not provide adequate protection.

VENTILATION: Local exhaust ventilation may be necessary to control any air contaminants to within their TLVs during the use of this product.

SKIN PROTECTION: Where contact is likely, wear chemical resistant gloves, a chemical suit and rubber boots.

EYE PROTECTION: Do not wear contact lenses. Wear safety glasses with side shields or goggles.

OTHER PROTECTIVE EQUIPMENT: Where splashing is possible, full chemically resistant protective clothing and boots are required.

HYGIENIC PRACTICES: Containers of this material may be hazardous when emptied. Since emptied containers retain product residues (vapor Liquid, and/or solid), all hazard precautions given in the data sheet must be observed. Wash hands before eating or smoking. Remove contaminated clothing and wash before reuse. Use only in a well ventilated area. Ground and bond containers when transferring material. Use spark-proof tools and explosion proof equipment. Avoid prolonged or repeated contact with skin. Avoid breathing vapors from heated material. Avoid contact with eyes, skin, and clothing.

\*\*\*\*\*

SECTION IX - SPECIAL PRECAUTIONS

\*\*\*\*\*

PRECAUTIONS TO BE TAKEN IN HANDLING AND STORAGE: Store away from incompatible substances. Wash thoroughly after handling. Keep away from heat, sparks and flame. Keep container closed when not in use.

OTHER PRECAUTIONS: Do not inhale mist or vapor. Keep out of reach of children. Apply with back to wind during outdoor application.

\*\*\*\*\*

SECTION X - HMIS RATINGS

\*\*\*\*\*

HMIS RATINGS - HEALTH: 2 FLAMMABILITY: 3 REACTIVITY: 1

\*\*\*\*\*

SECTION XI - OTHER REGULATIONS

\*\*\*\*\*

SARA SECTION 313: This product contains the following substances subject to the reporting requirements of Section 313 of Title III of the Superfund Amendments and Reauthorization Act of 1986 and 40 CFR Part 372:

----- CHEMICAL NAME -----	CAS NUMBER	WT/WT % IS LESS THAN
Methyl Alcohol	67-56-1	15.0 %

PREVIOUS MSDS REVISION DATE: 06/28/00

LEGEND : N.A. - Not Applicable, N.E. - Not Established  
N.D. - Not Determined

\*\*\*\*\*

\*\*\*\*\* DISCLAIMER \*\*\*\*\*

\*\*\*\*\*

\*\*The Nelson Paint Company, Inc. (TNPC) expressly disclaims all expressed or implied warranties of merchantability and fitness for a particular purpose, with respect to the product or information provided herein.\*\* All information appearing herein is based upon data obtained from the manufacturer and/or recognized technical sources. While the information is believed to be accurate, TNPC makes no representations as to its accuracy or sufficiency. Conditions of use are beyond TNPC's control and therefore users are responsible to verify this data under their own operating conditions to determine whether the product is suitable for their particular purposes and they assume all risks of their use, handling, and disposal of the product, or from the publication or use of, or reliance upon, information contained herein. This information relates only to the product designated herein, and does not relate to its use in combination with any other material or in any other process.

\*\*\*\*\*

(END OF MSDS)