

**REQUEST FOR QUOTATIONS**  
**Kitchen and Bath Countertop Project**  
**Unit #1148, Malott Homes, Malott, WA**

This is a request for quotation to provide countertops for the proposed project.  
Basic quotation amount to include delivery costs to site.

Email quotes to: [eric.eberlein.hsg@colvilletribes.com](mailto:eric.eberlein.hsg@colvilletribes.com) by March 12, 2024

**Quote must contain the following information:**

- 1. Basic quote amount including delivery.**
  - a. Deliver to 42 Convalescent Center Boulevard, Nespelem, WA 99155**
  - b. Google Maps location: <https://goo.gl/maps/Sm6AeLmT8Wi71E2D9>**
- 2. Drawing of proposed countertop layout.**
- 3. Countertop specifications**
- 4. Estimated date of delivery.**

Provide preformed laminate counter tops to match the attached layout. Verify all final measurements with CIHA before manufacturing.

Preferred options:

- Cultured marble vanity tops/sinks in bathrooms are an option.

**PLASTIC-LAMINATE COUNTERTOPS**

- Quality Standard: KCMA A161.2.
- Configuration: Provide countertops with the following front, cove (intersection of top with backsplash), backsplash, and endsplash (or sidesplash) style:
  - Front: Integral rolled configuration of plastic laminate
  - Backsplash: 4-inch vertical face of plastic laminate with plastic laminate top edge.
  - Endsplash/sidesplash: Match backsplash color – sidesplash should be wide enough to allow for scribing to fit the wall.
- Plastic-Laminate Substrate: Particleboard not less than 3/4 inch thick.
- Build up countertop thickness to 1-1/2 inches at front, back, and ends with additional layers of particleboard laminated to top.
- Side splash required at all wall termination points.

**COUNTERTOP MATERIALS**

- Plastic Laminate: High-pressure decorative laminate complying with NEMA LD 3.
  - Manufacturers: Subject to compliance with requirements, provide products by one of the following:
    - Formica Corp.
    - Lamin-Art, Inc.
    - Pionite Decorative Surfaces.
    - Wilsonart International.
- Provide through-color plastic laminate.
- Colors: Provide a minimum of 10 colors to choose from.

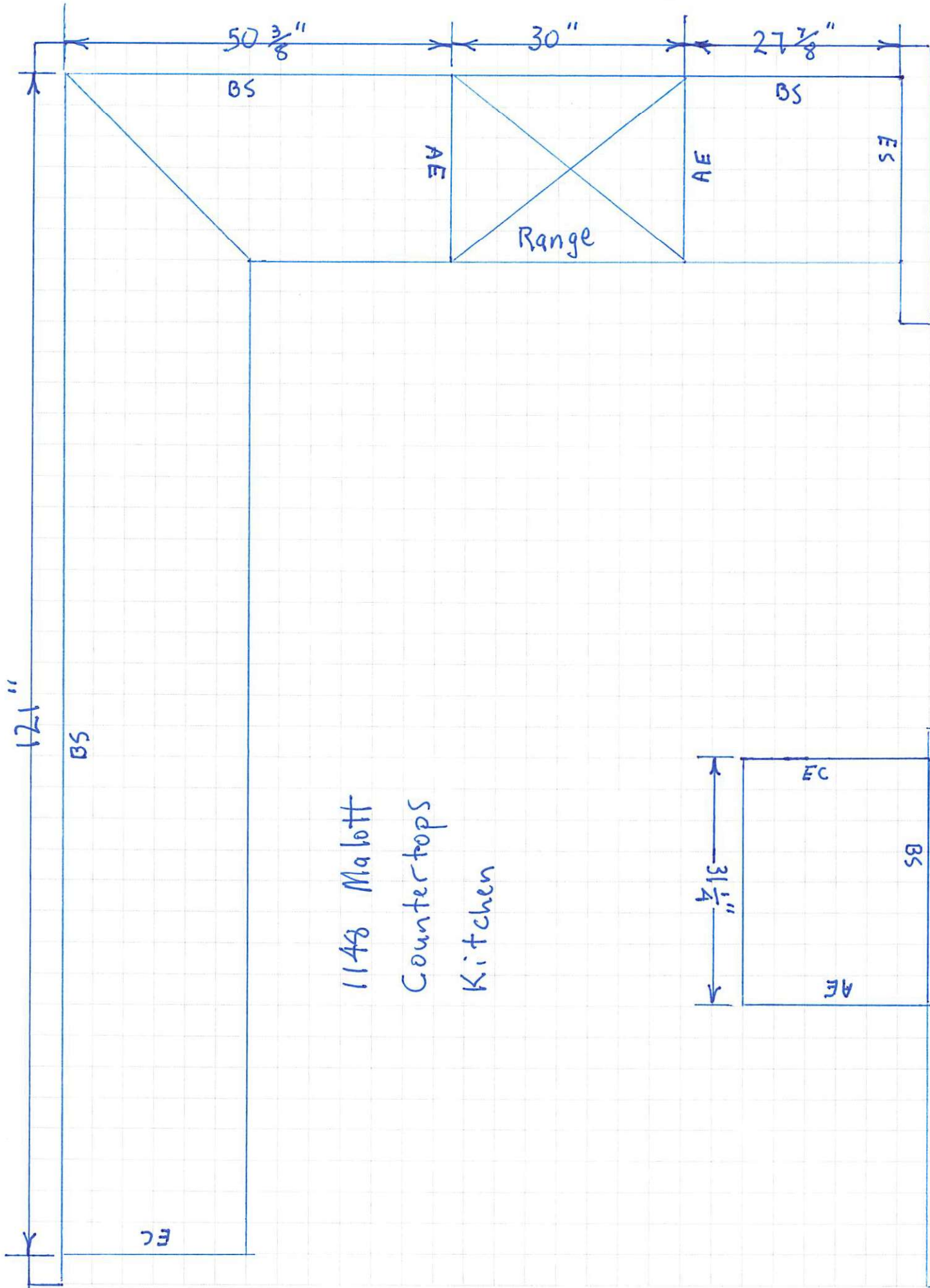

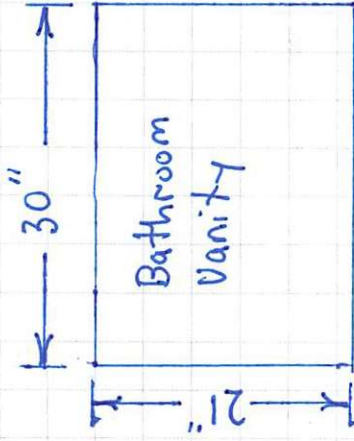

Top View

Vanity  
Height  
 $34\frac{1}{2}"$

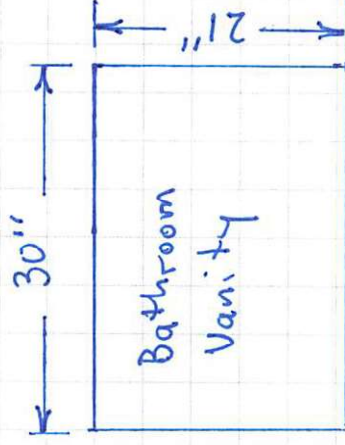

Top View

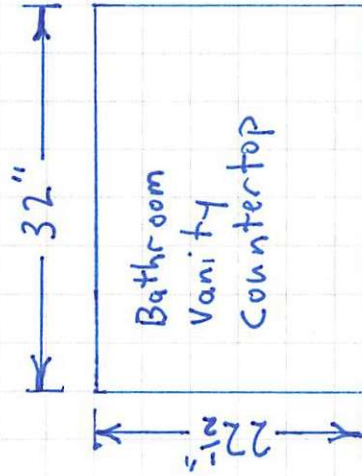

Top View

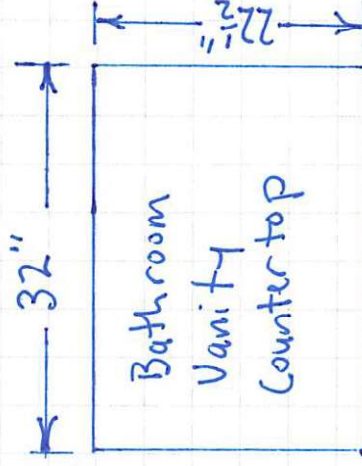

Top View

1148 Malott  
Bathroom Vanities and Countertops

1148 Malott  
Utility Room  
Cabinet and Countertop

